

9&HT0B DFC>9HC 9 9B 9B<9F=5 @B8Z D0F \$;1:1 CFI 0T1\$ SIFSS D8H kAtS=7&8& \$;-) +\$

1C4-21141AC 84C 84K&C-1-CE14C 84C 84K&C									
F9B	84K&C	F99B	7&B	6&H 9	AE 9H&S	C<99	9&B		
\$'A)	\$'1\$	\$'5	\$'5	\$'5	\$'5	\$'5	\$'5		

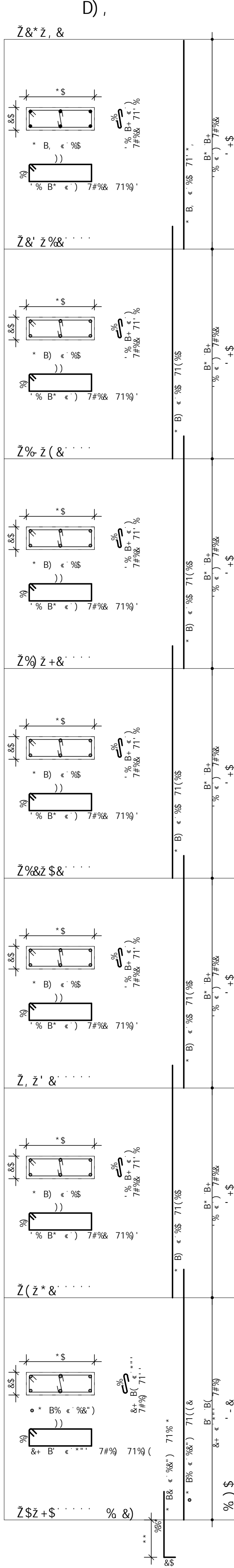
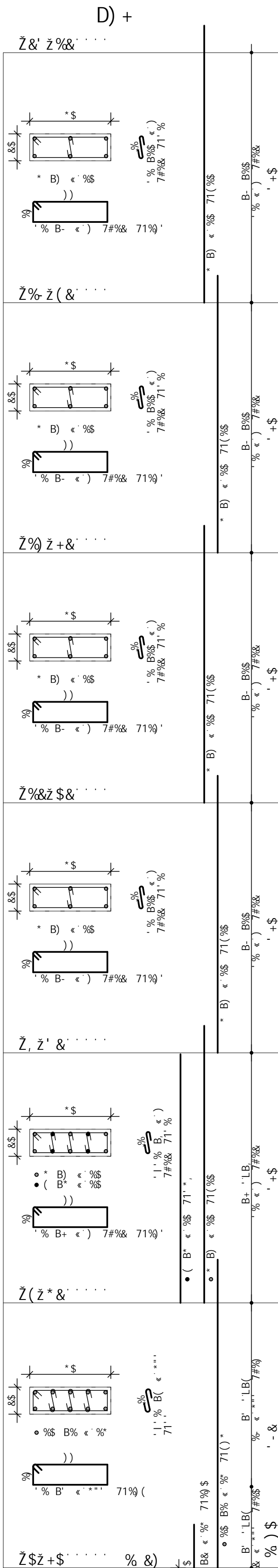
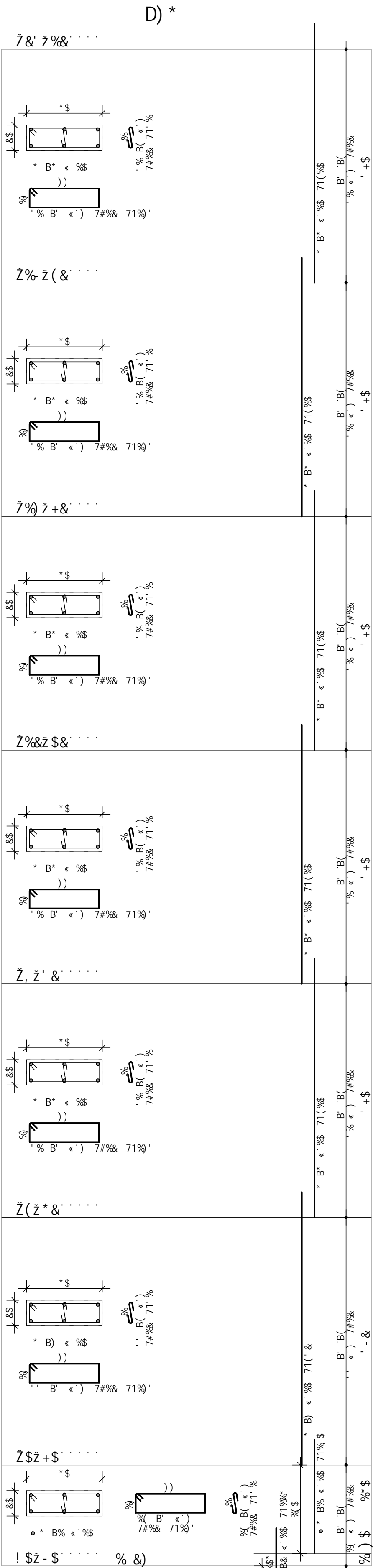
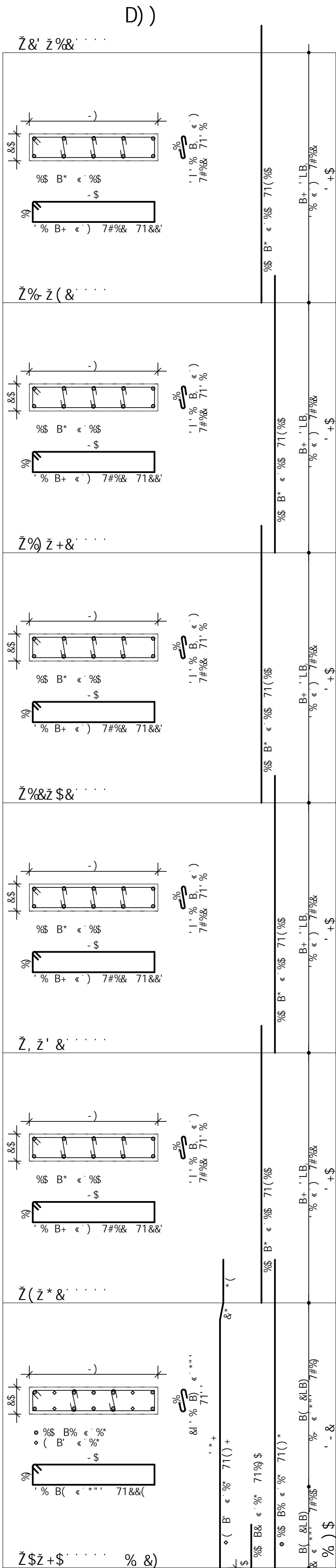

BCH5G

% 8=A9B0C9G 9A 79BH=A9F0GZ 9@9J5uE9G 9A A9HF0G
& 70B7F9HC 9GHFI HI F5@
W 21' \$ ADU 9H0H75G H=DC F5=NL 1' 5F: 5A5G05/
70BGI AC 89 7=A9BHC21'SS2\$.[#a / F9@5uEC 5#7 9BH9F 9 S2' 9' S2' /
5: F9 5BC 1 5F9=5'
W 21' \$ ADU 9H9A5=G 9@9A9BHC 9GHFI HI F5=GL 70BGI AC 89 7=A9BHC
70BGI AC 89 7=A9BHC 21' SS2\$.[#a'
SHCF a: 15#7=A9BHC AaL=AC 'S2' \$
' 7@5G09' 89 5: F9G0=J=8589 '=1' 1 F65B5
' A68I @C 89 9@5GH=7=8589 =B=7=5@' 5' & 8=5G: =15@' 5' \$' \$' ADU
' F95@=NSF' CG DFC79B=A9BHC 89 7I F52' F9H=F5B5' 89: CFA5G 9' 8C'
9G7CF5A9BHC 7CB CFA9 B6F 9C' ' % &S\$ (' 9 A9ACF=5@ 89G7F=H=J=C'
DFC79B9F 7CA 5 7I F5 1A=85 DCF BC AaB=AC 5' 9H9H 8=5G CI'
1H=@=NSF' 5 7I F5 EI Aa=75 8CG 9@9A9BHC 89 7CB7F9HC'
' 5 9L97I uEC 85 9GHFI HI F5 89J9FA 7CBH5F 7CA C 57CAD5B<5A9BHC 89 1A'
H97B0@C=G45' 89 7CB7F9HC
' C' 9B 9B<9=F C' F9GDCBGAJ9@ D9@5 C6F5 89J9FA C698979F 5G
' F97CA9B85uE9G 85G BCFASG Hv7B=75G 5D@=7AJ9=G2 89B=75BFC 9GD97=5@
5H9BuEC CG G9 1=BH9G 5H=J=8589G
' % 7CB7F9HC ' DF9D5F C2 7CBHFC@92' F979@=A9BHC' 1H F5BGDCFH92
' @5Bu5A9BHC2' 589BGS9A9BHC 9 7I F5
' & ' eFA5 7CB 9FA87=5 85G A9B=BSG 9 DOG=uE9G2 @AD9N52
' 9GH5BEI 9=85892 G5H F5uEC 85G: eFA5G 56GCF J9BH9G 9H9H F5F'
9L79GCG 89 a: 15L2 7I =858C 7CA C 1 GC 8CG 89GAC@85B9H9
9 F9H=F5B5 85G: eFA5G
' 5FA5uEC @AD9N52 ACBH5 9AZ 7CBF=A9BHC 9H 8C 89 9GD5u8FC9G
' D@BGH=7CG 589E1 58CGL2 9': 5F5BH=5 B5 DCG=uEC 85G 5FA5H F5G
' 5BH9G 9 8I F5BH9 5 7CB7F9H5 9A
' 7CBF=A9BHC AaB=AC 85 5FA5B1 F5
' @5>9G1&2 \$W/ J = 5G 9 D=6F9G1&2 W/ 6#HC7G1) 2\$7A/ 9GH575G1(2 \$W'
' C6F5 7CA Fa =8C 7CBHFC@9 89 EI 5@=8589'
' F97CA9B85I G9 EI 9' CG ASH9F=5=G 15uC 9 7CB7F9HCL 1H=@=N58CG
' B9GH9 DFC>9HC G9=5A GI 6A9H=8CG 5 9BG5=CG H97B0@C =7CG
' DF9J9F 8F9B5 9A 9' CI 'AD9FA956=@=N5uEC D5F 5 5G 7CFH=B5G
' 17CBH9Bue9GL'
' 7CB 9F=F A9B=85G BC @C75@'

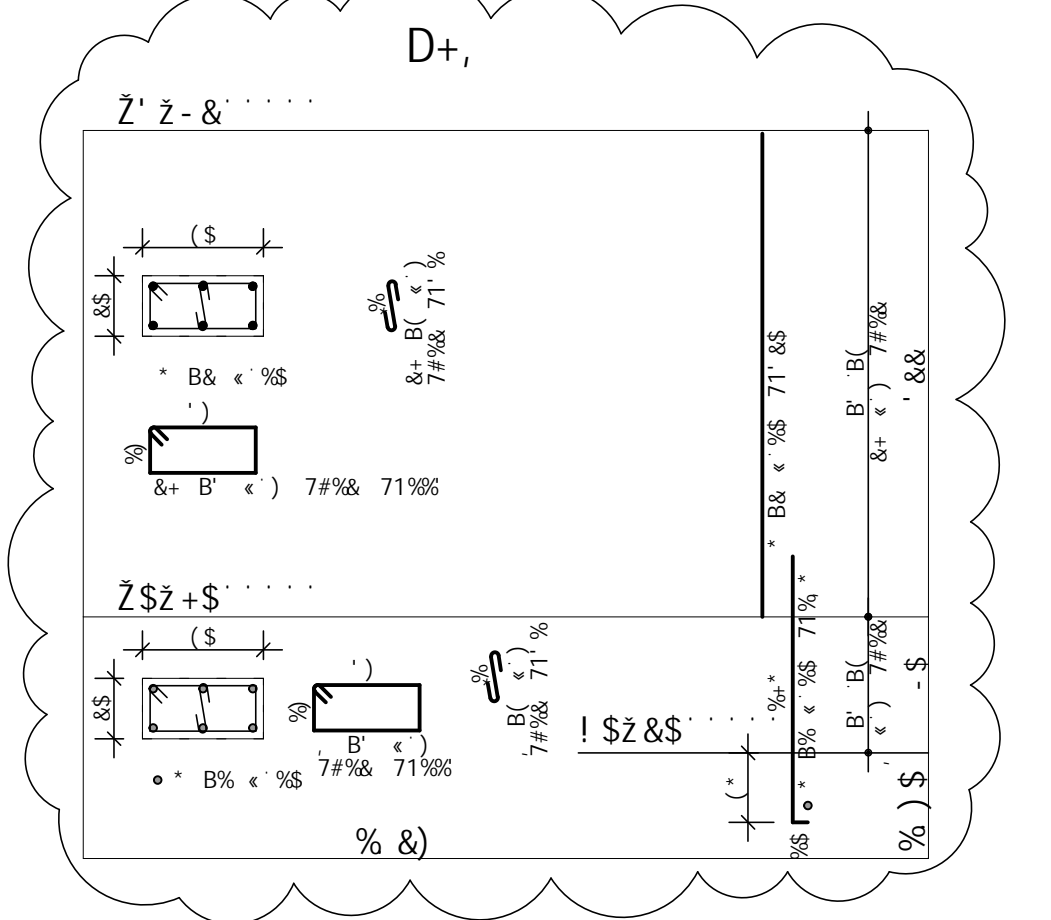
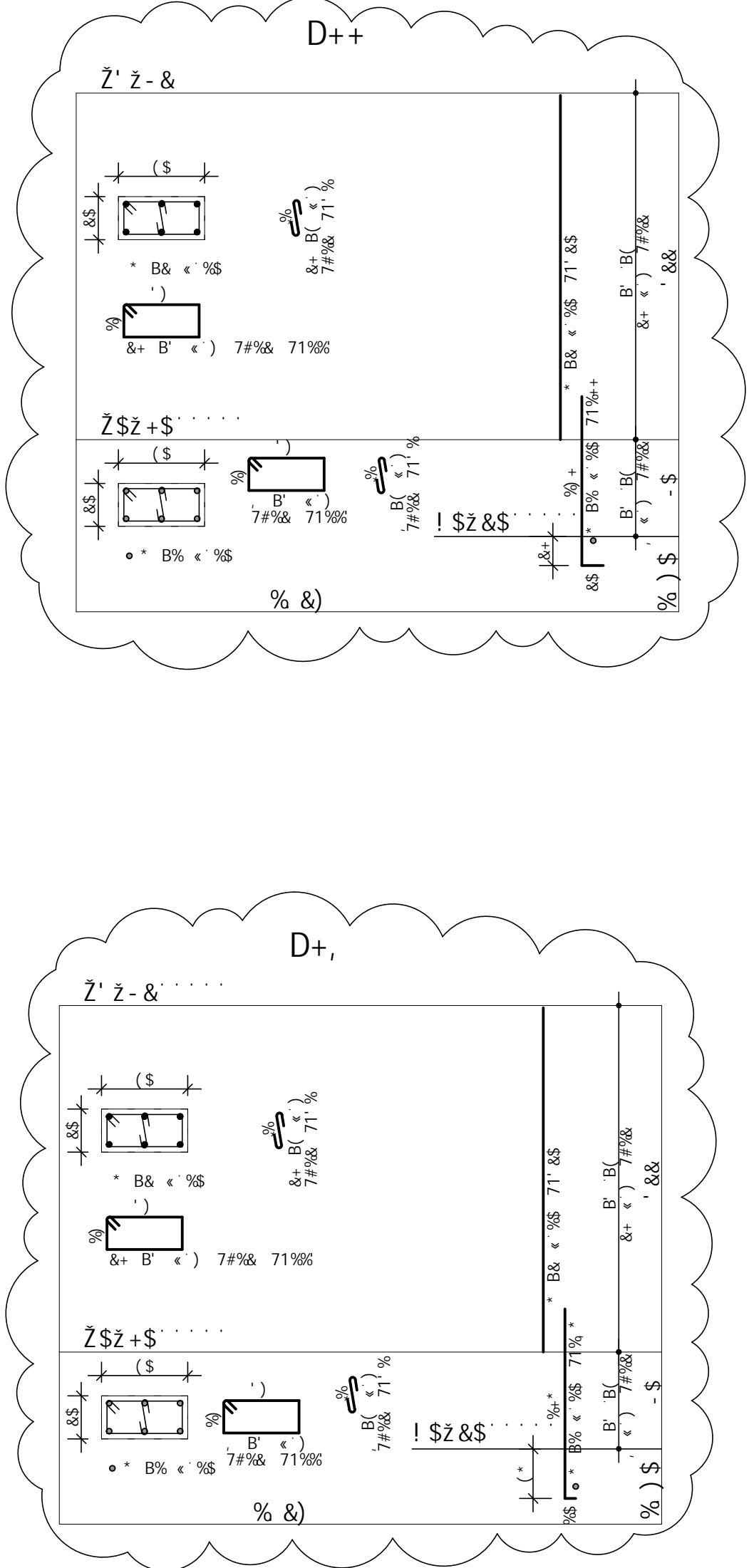

5uC	DCG	6=H	EI 5BH	7CADF=A9BHC	1B=H	HCH5@
	aa			Va		Va
D))						
	\$5	%	%	%	() *	() *S
	\$5	&	%	%	90 \$	90 \$S
	\$5	(%	%	() +	% &
	\$5	(%	%	&@	85(
	\$5)	%	%	&S	85(
	\$5)	%	%	&S	\$S
	\$5	+	%	%	&S	\$S
	\$5		%	%	&S	\$S
D) *						
	\$5	%	%	%	% \$	%S *
	\$5	&	%	%	90'	%S *
	\$5	(%	%	&S&	90' \$-S*
	\$5	(%	%	&S&	90' \$-S*
	\$5	+	%	%	\$	90' \$-S*
D) +						
	\$5	%	%	%	() *	() *S
	\$5	&	%	%	90 \$	90 \$S
	\$5	(%	%	90	90' (-
	\$5	(%	%	\$	90' (-
	\$5	+	%	%	%&	90' (-
	\$5	+	%	%	%	90' (-
	\$5	%	%	%	%&	90' (-
D),						
	\$5	%	%&	%	(&	&)
	\$5	%	%&	%	90	90
	\$5	(%	%	&+	90
	\$5	(%	%	\$	90
	\$5	+	%	%	%	90
	\$5	+	%	%	%	90
D++						
	\$5	%	%	%	%+	%S * &
	\$5	&	%	%	&S	% &S
	\$5	(%	%	90%	90%
D+,						
	\$5	%	%	%	% *	90%&
	\$5	(%	%	90%	90%
	\$5	(%	%	%	90%

F9GI AC 89 5uC			
5uC	6=H	7CADF	D9GC
	aa	a	1Z
	\$5	% \$	&)
	\$5	%	8%
	\$5	%	8%
	\$5	%	8%
DYgc HchU	\$5 1		& (Z
DYgc HchU	\$5 1		+ (Z

9L9	\$&	F9J=GE' 8CG D=@5F9G '=B8=758CG	9=7a7=5	&+#\$-#&&
9L9	\$%	5J5@=5uEC 89 7CB CFA=8589	9=7a7=5	% %&#&&
9L9	\$\$	DFC>9HC 9L97I H=J C' 1 @=7=H5uEC C6F5	9=7a7=5	' %\$+ #&&
F9J 7CAD	\$&	F9J=GE' DFC>9HC 9L97I H=J C' 1 F9: 9L9' &	9=7a7=5	& (#\$+ #&&
F9J 7CAD	\$%	F9J=GE' DFC>9HC 9L97I H=J C' 1 F9: 9L9	9=7a7=5	\$' \$+ #&&
F9J 7CAD	\$\$	9A=GGEC '=B=7=5@ 9L97I H=J C	9=7a7=5	8) #5 (#&&
5BH	\$%	F9J=GE' 5BH9DFC>9HC	9=7a7=5	\$&\$ #&& &&
5BH	\$\$	9A=GGEC '=B=7=5@ 5BH9DFC>9HC	9=7a7=5	8) #90#%
H=DC	F9J	89G7F=uEC	89G9B<C	85H5
F9J=GE9G				
A=B=CHV=F=C' DI 6@=7C' 8C' 9GH58C' 89' A=B5G' 9F5=G G989 85G' DFACACHFC=5G 89 >I GH=u5 89 >I =N 89' CF5				
9B89F9uC.			aF95' H9FF9BC.	
F1 5' >GV 75@= 5<CI 5; =2' @CH9: 2' 65=L5B5' 8C' D5F5=6I B5			&*--' 2' \$a& aF95' 7CBGHFI 8B5. ' +&*2' *a&	
DFC0F=9H&F=C.			7BD>.	
			8\$* -+%) +\$#\$9\$ ()	
DFC7I F58CF=5' 9F5@ 89' >I GH=u5' 8C' 9GH58C' 89' A=B5G' 9F5=G				
DFC>9HC 89' 9GHFI HI F5' 89' 7CB7F9HC' 5FA58C				
9ADF9G5.			7BD>.	
9B 9B<9=F C' 56FA7=C' G=@J 5' @A5				
7F95.' , \$' \$, I A.				
9=7a7=5 DFC>9HC 9' 7CBGI @HCF=5' @H85				
F9GDCBGAJ9@ Hv7B=7C.			7F95. ' &* & (#8I A.	
B9@GCB 1 F=5G D=BHC' 5F=; @=C' B5' G=@J 5				
7CBH9 8C. 5FA5uEC 89' D=@5F9G' 1' \$-#%&			85H5. &+ #5- #&& 9G75@5 =B8=7585	: C@<5. ') #%&*

